

PERMIT APPROVAL SPECIFICATIONS

Owner information:

John Gobel and Patricia Warner

Name

70 Meadow Drive

Mailing address

Bluffton, SC

29901

City

05-118

Permit Number

6 21N 25W

S T R

12/6/04

Date Submitted

2/9/05

Date Approved

2/9/06

Expiration Date

Permit Specifications:

This permit is approved with the following specifications:

1000

size of septic tank

187.5

lineal feet of drainfield

(375square feet of drainfield)

YES any special design for the system. List design specifications:

Install a Standard Absorption Trench System. Remember to keep the trenches no deeper than 36 inches. Install laterals in 2 trenches, each trench 100 feet in length and 2 feet wide. Please follow all county wastewater regulations & the state regulations as outlined in Circular DEQ 4 2002 edition. Install the system exactly as per approved lot layout. Pre-notification is mandatory before backfilling system.



Initials of Sanitarian

[Handwritten initials]

AS-BUILT SKETCH
AND
STATEMENT OF ACCURACY OF INSTALLATION

Land owner's name John Fabel

Permit number 05-118 (Curt House)

I, DAN STINNETT, as the licensed installer or landowner for the following system have constructed or altered the septic system on the parcel referenced by the permit number above.

I do hereby declare that the EXACT specifications of the approved permit have been followed. Accompanying this statement is a copy of the county approved lot layout and my as-built sketch. My as-built sketch is included on another sheet of paper. I understand that it is my responsibility to submit the above within 10 days of the completion of the system.

Installer's Signature Dan Stinnett

Installer's License Number LI-PN 32

Completion Date of System 6-17-2005

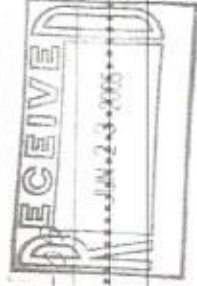

Checklist of as-built sketch:

- North Arrow
- Triangular measurements from two corners of house to tank access lid
- Measurement of pipe from tank to D-box or manifold
- All parcel boundaries
- Distance between the system and at least two parcel boundaries

Additional information needed (fill the blanks in with quantitative data):

100 length of drainfield laterals
2 number of drainfield laterals
1000 volume of septic tank

Permit # 05-118
 John Gavel - Owner

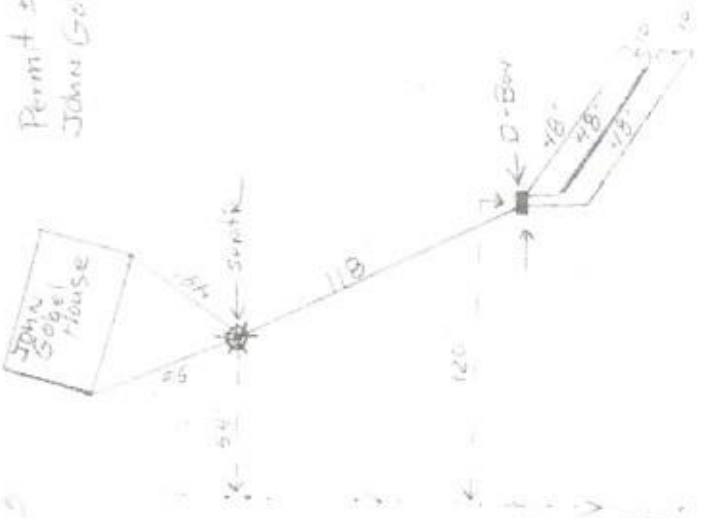

Water Source Spring

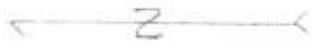

Occasional A-frame

201'

6/17/05
 6/17/05

- Sewer
- D-Box
- ... to Stream

Installed
 6/14-17-2005
 DAN STANNETT LI-ENG

