

MISSOULA CITY-COUNTY HEALTH DEPARTMENT
301 W. Alder 523-4755

INDIVIDUAL SEWER SYSTEM INSPECTION REPORT

Name of Owner John Magki
Legal Address/Location Lot 2 State lease Sperry Gade Rec sites
Certified Installer Deer Creek Exc

Type System: New Replacement
Septic Tank: Capacity: 1000 gal. Other gal., Material: Concrete Other , Depth to top: 1 ft. 6 in.
Drainfield: Total length 200 ft., # of laterals 3, Trench Depth 24-36 in. to bottom
Seepage Pit: Height ft., Depth to Top ft. in
Distance of Installation From: Property Lines: - Wells: 100' Surface Water: - Other -

Soil Type Sandy Loam

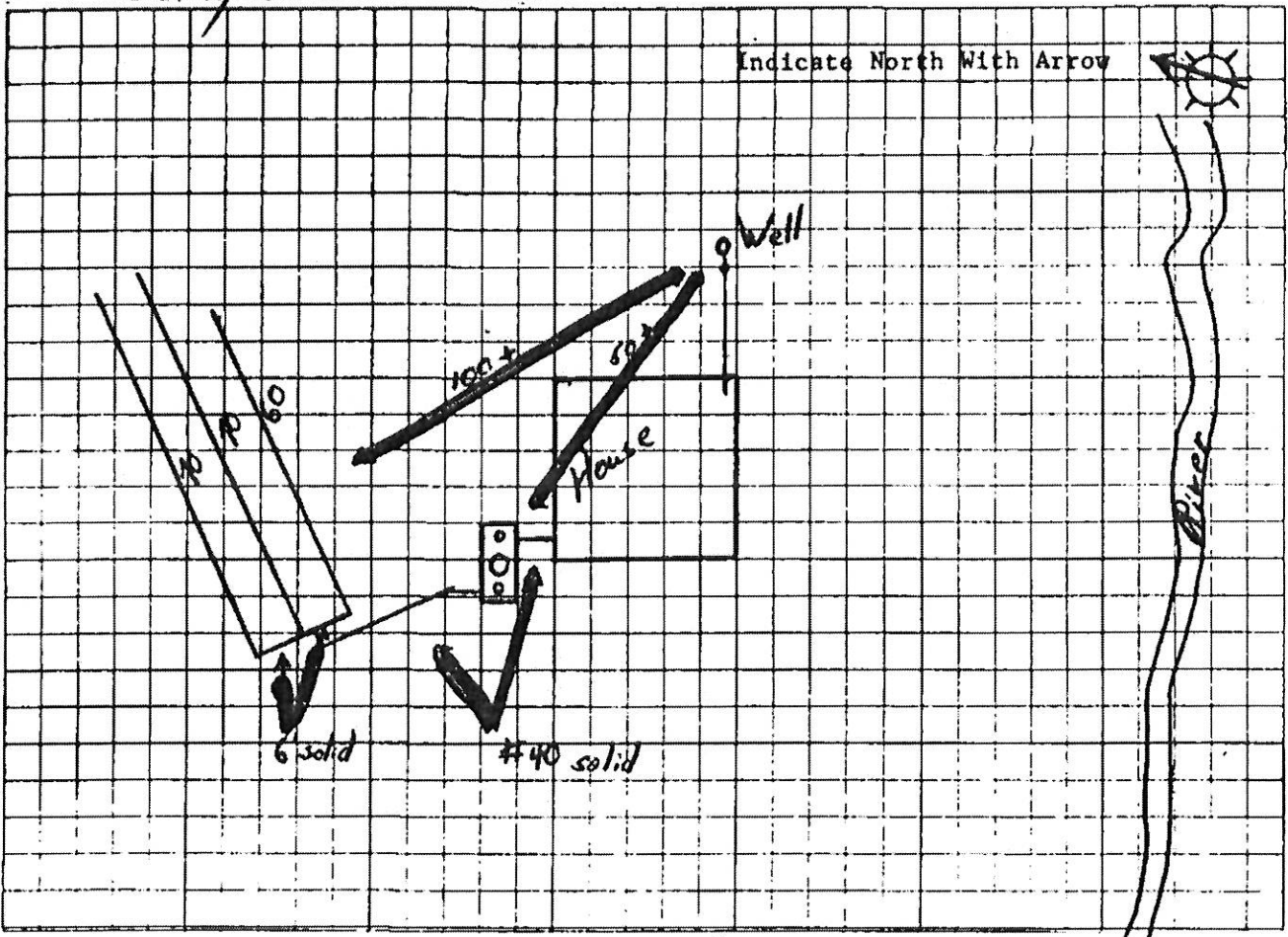

Installation Inspected: Approved Disapproved
[Signature] Sanitarian 4/15/98 Date

Corrections Necessary: _____

Inspection Witnessed By: _____ Date _____

Deficiencies Corrected: yes no _____ Sanitarian _____ Date _____