

Close

IDAHO DEPARTMENT OF WATER RESOURCES  
 Adjudication Claim Report

11/05/2006

*> CHECK ON BIG FLAT RIGHTS*

WATER RIGHT NO. 75-13964

<b>Owner Type</b>	<b>Name and Address</b>
Current Owner	YERDEN LIVING TRUST PO BOX 98 NORTH FORK, ID 83466-0098
Trustee	THOMAS R YERDEN 15345 N 95TH ST LONGMONT, CO 80504 (303)772-1967
Trustee	YERDEN LIVING TRUST PO BOX 98 NORTH FORK, ID 83466-0098
Original Owner	DON R BELLAMY PO BOX 1031 SALMON, ID 83467 (208)756-4458
Original Owner	LOUISE C NELSON PO BOX 1186 SALMON, ID 83467 (208)865-2453
Original Owner	FRANK R NELSON RT 1 BOX 1186 SALMON, ID 83467 (208)865-2453

Priority Date: 04/01/1896  
 Basis: Decreed  
 Status: Active

<b>Source</b>	<b>Tributary</b>
---------------	------------------

FOURTH OF JULY CREEK | SALMON RIVER

Beneficial Use	From	To	Diversion Rate	Volume
IRRIGATION	04/01	08/01	0.32 CFS	
IRRIGATION	08/02	11/01	0.32 CFS	
Total Diversion			0.32 CFS	

Location of Point(s) of Diversion:

FOURTH OF JULY CREEK	SESENE	Sec. 20	Township 24N	Range 22E	LEMHI County
FOURTH OF JULY CREEK	SESWSE	Sec. 20	Township 24N	Range 22E	LEMHI County

Place(s) of use:

Place of Use Legal Description: IRRIGATION LEMHI County

Township	Range	Section	Lot	Tract	Acres	Lot	Tract	Acres	Lot	Tract	Acres	Lot	Tract	Acres
24N	22E	29		NWNE	8									

Place of Use Legal Description: IRRIGATION LEMHI County

Township	Range	Section	Lot	Tract	Acres	Lot	Tract	Acres	Lot	Tract	Acres	Lot	Tract	Acres
24N	22E	29		NWNE	8									

Total Acres: 16

Dates:

Licensed Date:

Claim Received Date:

Decreed Date:

Enlargement Use Priority Date:

Enlargement Statute Priority Date:

Other Information:

State or Federal: S

Owner Name Connector: AND

Water District Number:

**DISTRICT SEVEN HEALTH DEPARTMENT  
SEPTIC SYSTEM INSPECTION REPORT**

Activity Code: 01 4/99

Travel Time: \_\_\_\_\_ Inspection Time: \_\_\_\_\_

INSPECTION CONDUCTED FOR: Name TOM YEARDON Permit No 3003 02

LOCATION OF INSPECTION: Street Address \_\_\_\_\_ City \_\_\_\_\_  
 Legal Description: 1/4 Section \_\_\_\_\_ Section \_\_\_\_\_ Township \_\_\_\_\_ Range \_\_\_\_\_  
 Subdivision: \_\_\_\_\_ Lot \_\_\_\_\_ Block \_\_\_\_\_

**SEPTIC TANK INSPECTION**

Capacity of Septic Tank Installed 1000 gallons. Septic Tank capacity = or greater than permit requirements?  Yes No N/A  
 Was Septic Tank construction in compliance with State regulations and was tank State approved?  Yes No  
 Were inlet and outlet properly sealed?  Yes No  
 Did Septic Tank meet minimum separation requirements as required by permit?  Yes No  
 Was extension of manhole required? Yes  No  Depth from final grade to manhole. 1 feet

**SUBSURFACE DISPOSAL (DRAINFIELD) INSPECTION**

Type of Disposal System installed \_\_\_\_\_ Meets permit requirements? Yes No N/A  
 Disposal Area Size \_\_\_\_\_ Square Feet In compliance with Permit Issued? Yes No  
 Did Disposal System meet the minimum separation distance as required by the Permit? Yes No  
 Was Disposal System constructed in compliance with the State Technical Guidance Manual? Yes No  
 Maximum depth of Disposal System \_\_\_\_\_ Feet In compliance with Permit Issued? Yes No

**DRAWING:** (Show buildings, septic system components, water lines, surface waters, & wells within 300 feet of septic system. Important to show distances.)

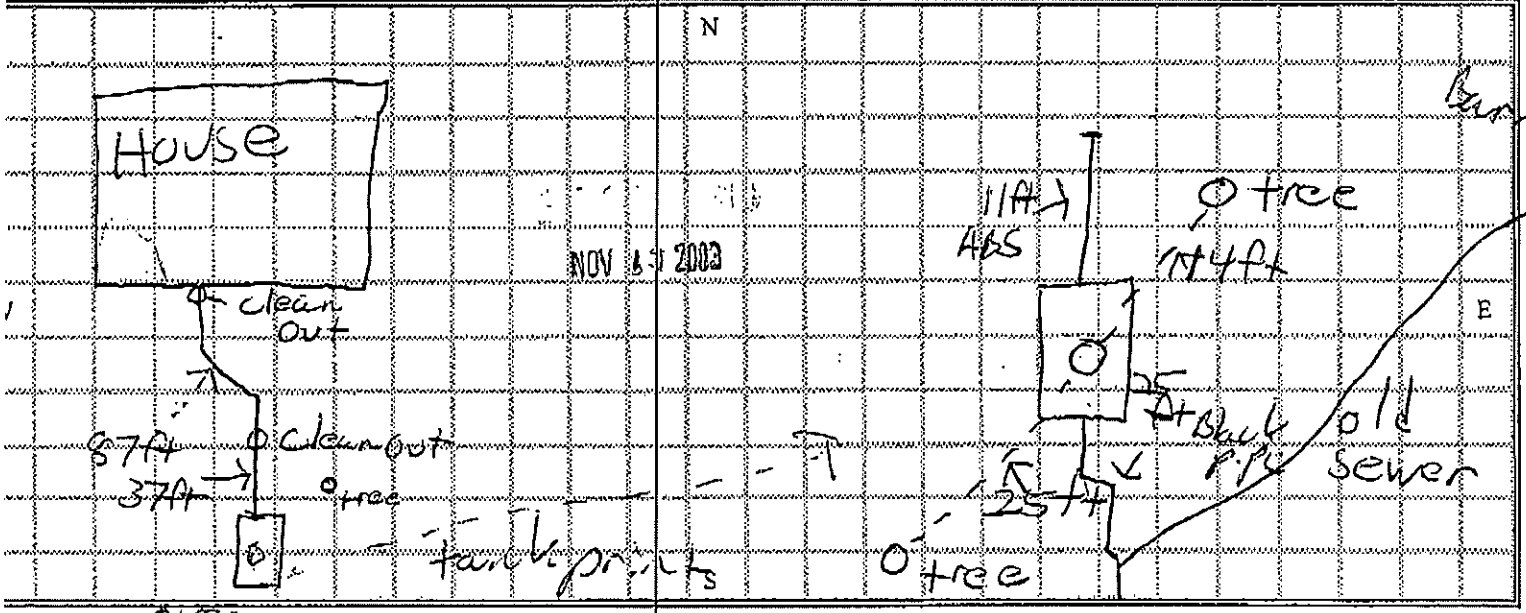

**SELF-INSPECTION:** If given approval for self inspection Installer certifies that information provided is accurate and system was installed as shown.

Installer's Signature X [Signature] License #: \_\_\_\_\_ Date: \_\_\_\_\_

Inspected by: [Signature] Official Use Only License #: \_\_\_\_\_  
 How System appears to:  
 Be in Substantial Compliance with permit and is approved.  Yes  
 Have Minor deficiencies which could cause premature failure, but still in substantial compliance with Intent of Rules.  Yes  
 Recommend that deficiencies be corrected, which could improve your system, but system is still approved.  Yes  
 Have Major deficiencies which violate the Intent of Rules and must be corrected, system not approved.  Yes

REVIEWED BY EHS: [Signature] DATE: 11/26/03