

32 31 22

SCALE 1" = 400'

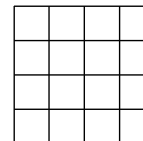

THIS MAP IS PREPARED ONLY FOR THE ADMINISTRATIVE USE OF FLATHEAD COUNTY AND IS NOT NECESSARILY AN ACCURATE REPRESENTATION OF THE LOCATION OR EXISTENCE OF TRACTS OF RECORD, THEIR BOUNDARIES OR EASEMENTS AND ROADWAYS.

"This plat is provided solely for the purpose of assisting in locating the land, and the Company assumes no liability for variations, if any, with actual survey."
First American Title Company

SURVEYS OF RECORD

- C.S.
- 2027- 3, 3B, 3C, 3D
- 2049- 3D
- 2744- 1, 2, 2A, 2B, 2AAA, 2AA, 2AAB, 2AAC
- 2889- 5AAC, 5AAB, 2B
- 2894- 2A, 5AAA
- 2895- 1, 2, 3A, 3C
- 3019- 2A, 2B, 2AB, 2B1
- 3247- 5AAC, 5AACA, 2B3
- 3248- 2B, 2B1, 5AAB1, 5AACC
- 3249- 5AA, 25C, 5AAB1, 5AAB2, 2B3
- 3250- 5AAC, 5AACA, 2B1
- 3298- 5AAC, 5AAA, 5AAF
- 3299- 5AAG, 5AAB1, 5AA1, 2AC
- 3248- 5AAG, 5AAB1, 5AAGC
- 3273- 5AA
- 3274- 5AAB, 5AAC, 2B, 5AABC, 5AACC, 5AAB1, 2B1
- 3275- 2
- 3276- 2C, 2CA
- 3285- 2, 2H
- 3291- 1A
- 3292- 2, 2F
- 3293- 1, 2
- 3723- 5AAC, 5AACE, 5AABDA, 5AAF
- 3730- 5AAB, 5AAC
- 10464- 5AAA, 5AAG, 5AAF, 5AAC, 5AA
- 12100- 51 PRINT
- 12540- 1, 1A EASE
- 12551- 3, 3B, 3C, 3D
- 13480- 3, 3A
- 13888- 2A, 2B1
- 13984- 2D, 2E, 3A
- 14320- 1B, 1C, 1D, 1E, 1F
- 14459- 1F, 1G, 1H
- 15219- 2H PRINT
- 15220- 2C, 2CA, 2CB
- 15532- 5AAJ, 5AAK, 2BDA, 2BDB, 5AAK, 5AA, 2B3, 2B4
- 15587- 2AE, 2AEB, 2AEC, 2B, 2B1A, 2B1B
- 15704- 2D, 2E, 2F
- 15783- 3D, 3DA, 3DB
- 15838- 2BB, 2BBA, 2BBA, 2BBA
- 16014- 2D, 2DA, 2DB
- 16514- 1, 1A, 1B
- 17912- 2E, 2AD, 2AAA, 2AA
- 18755- 1D, 2C, 2CC, 2CD

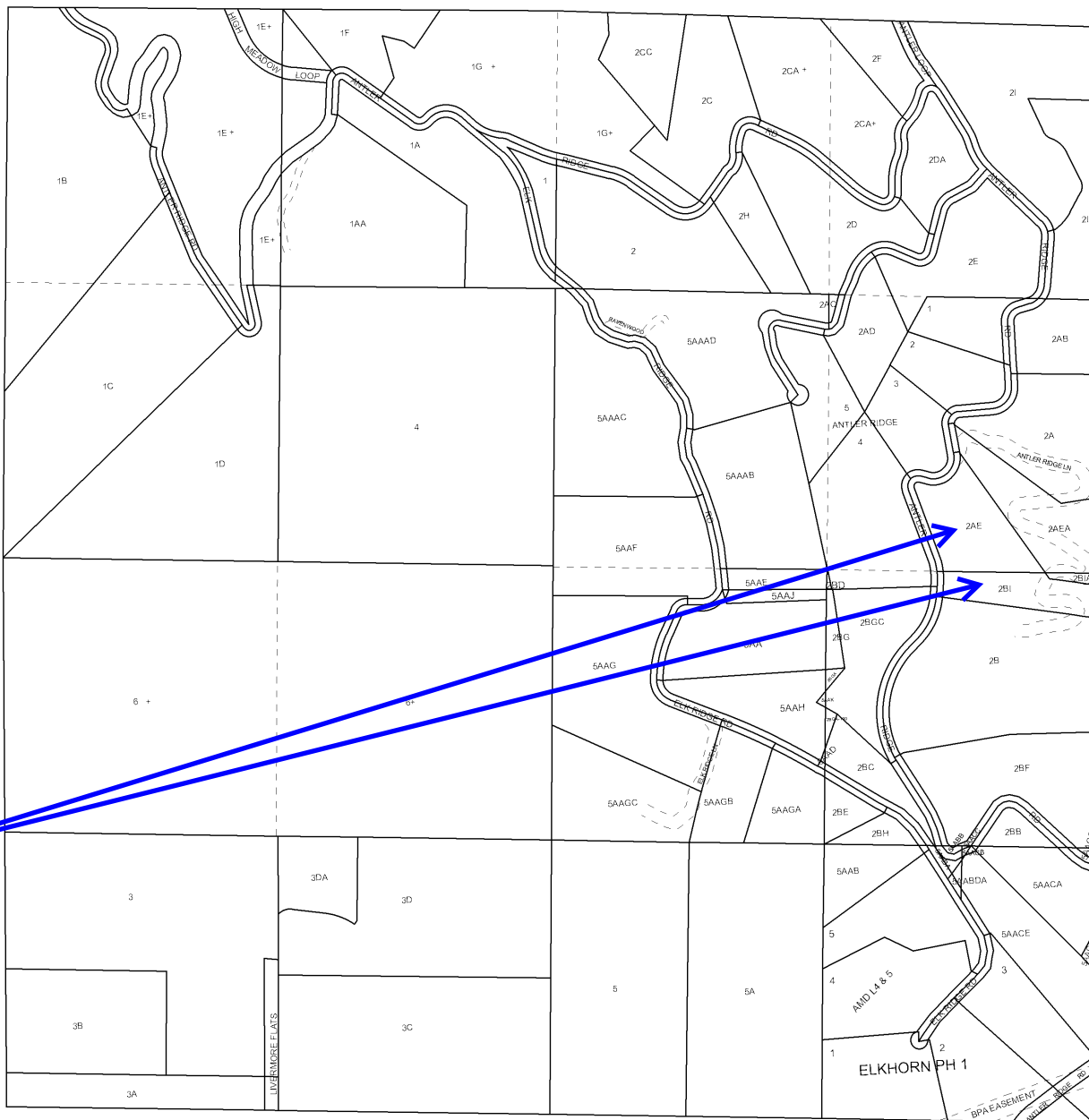

SUBJECT

Tn. 2A6 + Tn. 2B1 = 0002727

OWNERS: Patrick J. Burns
PURPOSE: Parcel A: Family Transfer
Parcel B: Remainder
DATE: December 10, 2002

Certificate of Survey

E 1/2 of Section 32, T31N R22W, P.M., M.

Flathead County, Montana



SUBJECT

PARCEL A
That portion of the East 1/2 of Section 32, Township 31 North, Range 22 West, P.M., M., Flathead County, Montana described as follows:

Beginning at the East 1/4 corner of Section 32;
Thence along the east line of the Southeast 1/4 of Section 32, South 00°08'33" East 59.71 feet;
Thence North 82°58'29" West 248.84 feet;
Thence North 36°00'22" West 751.06 feet;
Thence South 79°15'32" West 30.00 feet;
Thence North 10°44'28" West 138.90 feet;
Thence North 79°15'32" East 30.00 feet;
Thence South 53°52'17" East 645.92 feet;
Thence North 80°46'58" East 193.59 feet to the East line of the Northeast 1/4 of Section 32;
Thence along the East line of the Northeast 1/4, South 00°13'37" East 364.94 feet to the Point of Beginning, containing 5.00 acres of land, all as shown hereon.
Subject to and together with easements as shown hereon
Subject to easements of record.

PARCEL B
That portion of the East 1/2 of Section 32, Township 31 North, Range 22 West, P.M., M., Flathead County, Montana described as follows:

Commencing at the East 1/4 corner of Section 32;
Thence along the east line of the Southeast 1/4 of Section 32, South 00°08'33" East 59.71 feet to the Point of Beginning;
Thence continuing along the East line, South 00°08'33" East 150.00 feet;
Thence North 82°55'48" West 292.48 feet to a point on a 350.00 foot radius curve, concave westerly, having a radial bearing of North 83°06'25" West;
Thence northerly along the curve through a central angle of 27°34'02" 168.40 feet;
Thence North 20°38'21" West 369.84 feet to a point on a 50.00 foot radius curve, concave southeasterly, having a radial bearing of North 69°15'44" East;
Thence northeasterly along the curve through a central angle of 124°33'01" 108.69 feet;
Thence South 76°25'59" East 39.04 feet to a point on a 100.00 foot radius curve, concave northwesterly, having a radial bearing of North 13°40'26" East;
Thence northeasterly along the curve through a central angle of 114°35'19" 199.99 feet;
Thence North 79°15'32" East 30.00 feet;
Thence South 36°00'22" East 751.06 feet;
Thence South 82°58'29" East 248.84 feet to the Point of Beginning, containing 7.47 acres of land, all as shown hereon.
Subject to and together with easements as shown hereon
Subject to easements of record.

OWNER CERTIFICATION
I hereby certify that the purpose of this division of land is to transfer Parcel A as shown on this Certificate of Survey to GINA BURNS, my WIFE. Furthermore, I certify that I am entitled to use this exemption and am in compliance with all conditions imposed by law and regulation on the use of this exemption. Therefore, this division of land is exempt from review as a subdivision pursuant to Section 76-3-207(1)(b), MCA.

PATRICK J. BURNS

STATE OF MT
County of Flathead ss.

This instrument was acknowledged before me on April 21, 2003
by PATRICK J. BURNS.

Dore Breake
Notary Public for the State of Montana
Residing at Whitefish
My Commission Expires April 1, 2006

CERTIFICATE OF SURVEYOR

Dawn Marquardt
Registration No. 73285

4-21-03
Date



STATE OF MONTANA
County of Flathead

Filed on the 23 day of April, 2003, A.D., at 1:50 o'clock p.m.

Shula Robinson
County Clerk and Recorder
By: Diana Adam
Deputy

Instrument Record No. 20031313500

CERTIFICATE OF SURVEY NO. 15587

Date: December 11, 2002	Revision Date: n/a
Project Name: Burns	Project Number: 02-349
Filename: Working	Drawn By: Augusta

Approved: 4/21 2003
Jan J. Bl
Examining Land Surveyor
Registration No. 54285

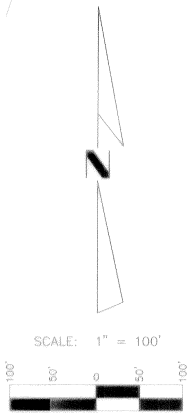

- LEGEND
- Found 1/4 corner as noted
 - Found 5/8" rebar "25165" per C. of S. 5714 & 6015
 - Found 5/8" rebar "73285" per C. of S. 13888
 - Set 5/8" by 24" rebar with cap marked "MARQUARDT 73285"

"This plat is provided solely for the purpose of assisting in locating the land, and the Company assumes no liability for variations, if any, with a actual survey."
First American Title Company

Marquardt & Marquardt
Surveying
285 1st Ave. E.N. Kalispell, MT 59901
tel: (406) 756-6285 fax: (406) 756-3055

COS 15587

"This plat is provided solely for the purpose of assisting in locating the land, and the Company assumes no liability for variations, if any, with actual survey."
First American Title Company

SUBJECT

