

Coastal Realty Homer

GRAVINA ISLAND PROPERTY



This uniquely Alaskan property is located on Gravina Island, just across Tongass Narrows from Ketchikan, Alaska. Access is by road from the Ketchikan Airport, or by ferry from the City of Ketchikan. There is deep moorage in front of the property, over 10 acres of patented tidal lands and 2,126 feet of water frontage. Bordered by the Tongass National Forest on one side and spectacular Clam Cove on the other end, this parcel also includes several wilderness lakes and a salmon stream. Property does have water rights from Round Lake and a power line easement. At over 292 acres this is the largest fee simple parcel in the area.





The sports fishing enthusiast will find a bounty in the waters surrounding the island, including King Salmon (Chinook), Silver Salmon (Coho), Red Salmon (Sockeye), Pink Salmon (Humpy), and Chum Salmon (Dog).

Halibut, Ling Cod, Red Snapper, and Rock Cod is also available as are several species of crab and shrimp.

There are numerous wilderness lakes and streams on Gravina Island that provide Steelhead, Dolly Varden, and Cutthroat Trout in addition to Red Salmon and Pink Salmon.

Gravina Island is also home to a small population of Sitka Black-tailed Deer, mountain goats, black bear, and great waterfowl hunting.

Outdoor adventurers will love the amazing kayaking, hiking, boating, and wildlife photography opportunities.



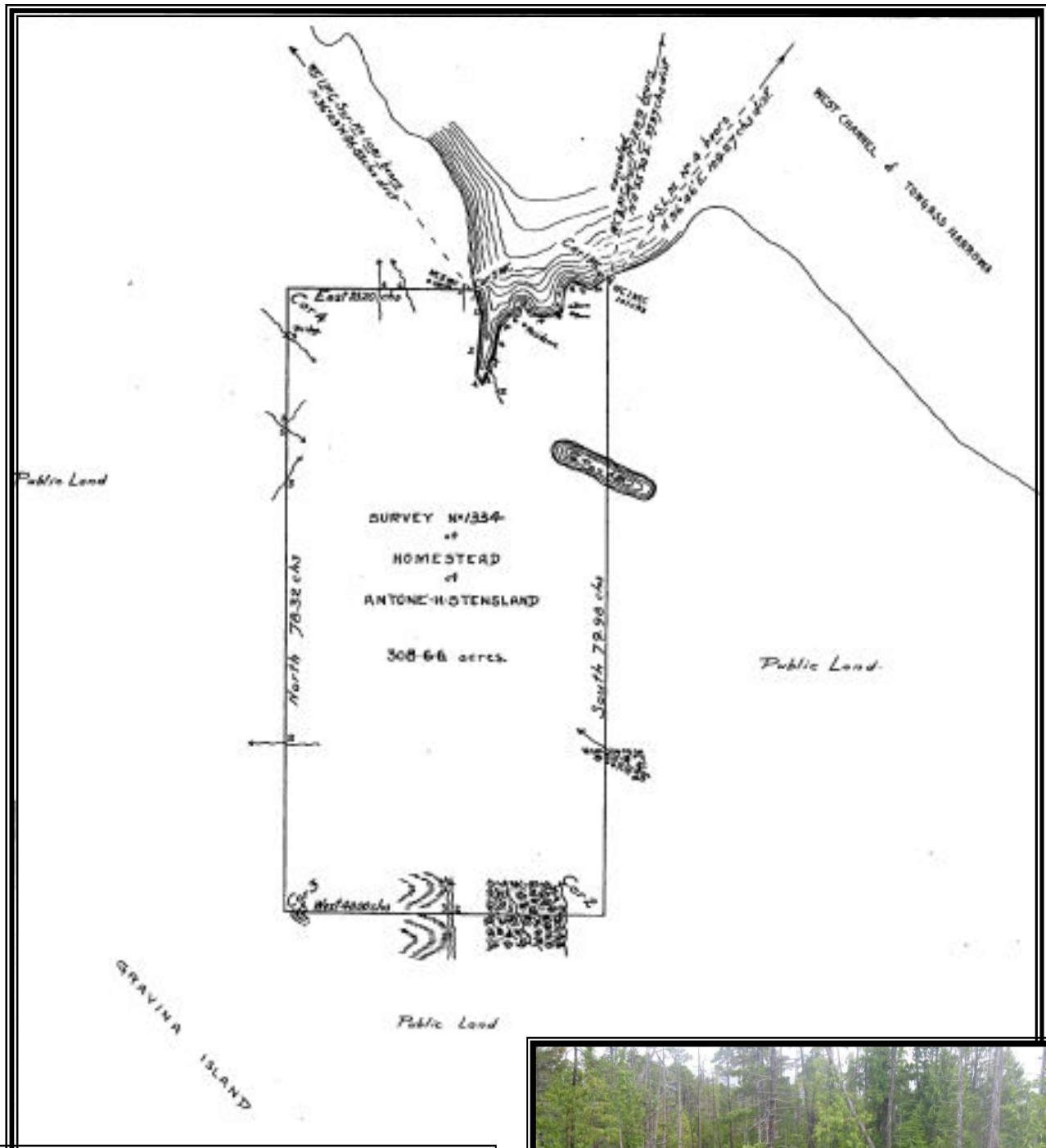



If you are interested in a little shopping or Southeast culture Ketchikan is only a half mile away, just across the Tongass Narrows. You can walk Creek Street's wooden boardwalks and explore the history of Ketchikan and the surrounding area by visiting the museums and other attractions. This property offers Alaskan wilderness and adventure with easy access to town and all it's services and attractions.



292.58 acre Gravina Island Parcel offered at \$1,500,000



Coastal Realty Homer
375 W. Pioneer Ave.
Homer, AK 99603
907-235-7700
www.alaskacoastalrealty.com
info@alaskacoastalrealty.com
Art Swisher/Owner broker
Ken Swisher/Associate

