

COUNTY ROAD No. 342  
(aka Cedarwood Road)

# LEGAL DESCRIPTION

DOUGLAS COOPER  
LOCATED IN SECTIONS 30, TOWNSHIP 24 SOUTH, RANGE 65 WEST, 6th P.M.  
COUNTY OF PUEBLO, STATE OF COLORADO

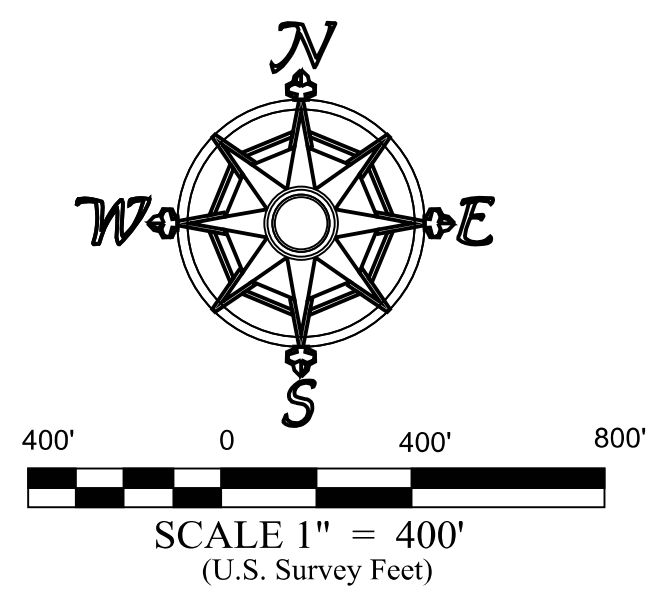

LANDS OF  
SIKES 8200  
PHASE I

LANDS OF  
MOREY

SW 1/4

N 1/2 NW 1/4

SE 1/4 NW 1/4

Claymine  
Road

Claymine  
Road

385.94 Acres

23.41 Acres

LANDS OF  
ARMSTRONG

**LEGAL DESCRIPTION:**

TOWNSHIP 24 SOUTH, RANGE 30 WEST  
Section 30: SW 1/4; E 1/2 NW 1/4  
Section 31: N 1/2 NW 1/4; SE 1/4 NW 1/4

Along with

A parcel of land located in the W 1/2 of the E 1/2, Section 30, Township 24 South, Range 65 West, of the 6th P.M., County of Pueblo, State of Colorado, being more particularly described as follows:

Beginning at the South 1/4 corner of said Section 30 (a 3/4" rebar, with aluminum cap, PLS 14599); thence N 00° 11' 41" W, along the north-south centerline of said Section 30, a distance of 2651.52 feet, to the center 1/4, corner of said Section 30 (a 3/4" rebar, with aluminum cap, PLS 14599); thence continuing N 00° 11' 55" W, along said north-south centerline a distance of 2426.02 feet, to the intersection of said north-south line and an existing fence line; thence along said fence line the following five (5) courses:  
 1) S 04° 14' 18" E, a distance of 4273.91 feet;  
 2) S 31° 04' 00" E, a distance of 739.24 feet;  
 3) S 87° 42' 03" W, a distance of 201.60 feet;  
 4) S 86° 45' 22" W, a distance of 132.26 feet;  
 5) S 04° 11' 59" E, a distance of 169.99 feet, to the south line of said Section 30; thence N 89° 31' 07" W, along said South line a distance of 358.89 feet, to the Point of Beginning. Containing 23.41 acres, more or less.

**Wachob and Wachob, Inc.**

Professional Land Surveyors, Colorado City, Colorado  
P.O. Box 19376, Zip 81019 Phone (719)-676-3665

Job Name: 2014-082.trv	
Scale: 1" = 400'	Drawn By: w.s.b
Date: 6-18-2014	
Job No. 2010-177	Sheet 1 of 2