

Tri-County Environmental Health (Granite, Powell, Deer Lodge Counties)

CERTIFIED INSTALLER REPORT FORM - DUE WITHIN 30 DAYS OF CONSTRUCTION

COUNTY: Granite Powell Deer Lodge

PROPERTY OWNER James Hill

PROPERTY ADDRESS 121 Deer Haven LN Deer lodge

CERTIFIED INSTALLER Andrew Legg

PHONE 406-552-7637

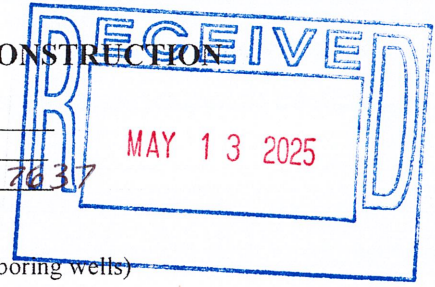

Please draw the septic system as built below. Include ALL of the following information:

Distance from wells to septic tank 300 FT wells to drain field 350 (include neighboring wells)

Distance from tank to foundation 30 FT drain field to foundation 60 FT

Distance from tank to drain field 15 FT Tank size and material 1500 Gall concrete

Tank to Distribution box 10 Effluent filter in tank outlet YES NO Distance to surface water/floodplain >100'? YES NO

Number and length of drainfield lines 5 - 60 FT Distance between lines on center 10

Depth of drain field minimum maximum

Type of drain field (pipe and gravel, chamber, sand-lined, other) chamber

Distance from property lines: drainfield 75 septic tank 135 well 350

Indicate North with Arrow

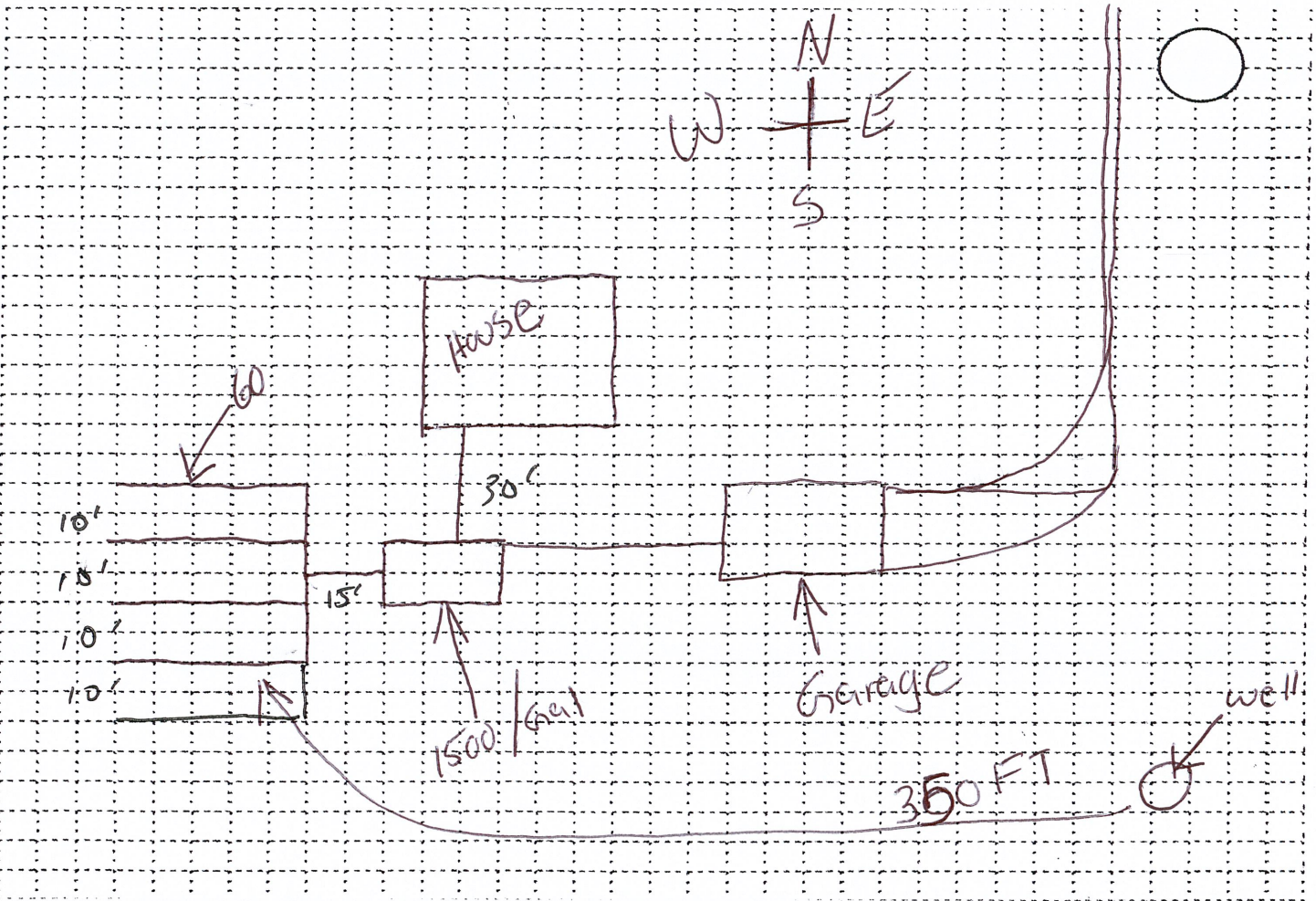

I attest that this system was installed in accordance with the septic permit and the Tri-County Environmental Health Onsite Wastewater Treatment Regulation and that the drawing accurately reflects what was installed.

Self inspected by: Andrew Legg

Certified Installer

5/13/25

Date

COUNTY USE

Drawing shows that system meets the requirement of the permit and Regulations. Yes ☒ No ☐

Corrections Necessary: N/A

Deficiencies Corrected: Yes ☐ No ☒

Final Approval? Yes ☒ No ☐

Sanitarian

Date

5/13/25