

Building Sketch

Borrower	Steven & Hollie Ashworth			
Property Address	21 Old Trail Point Rd			
City	Noxon	County	Sanders	State MT Zip Code 59853
Lender	Rocky Mountain Bank			

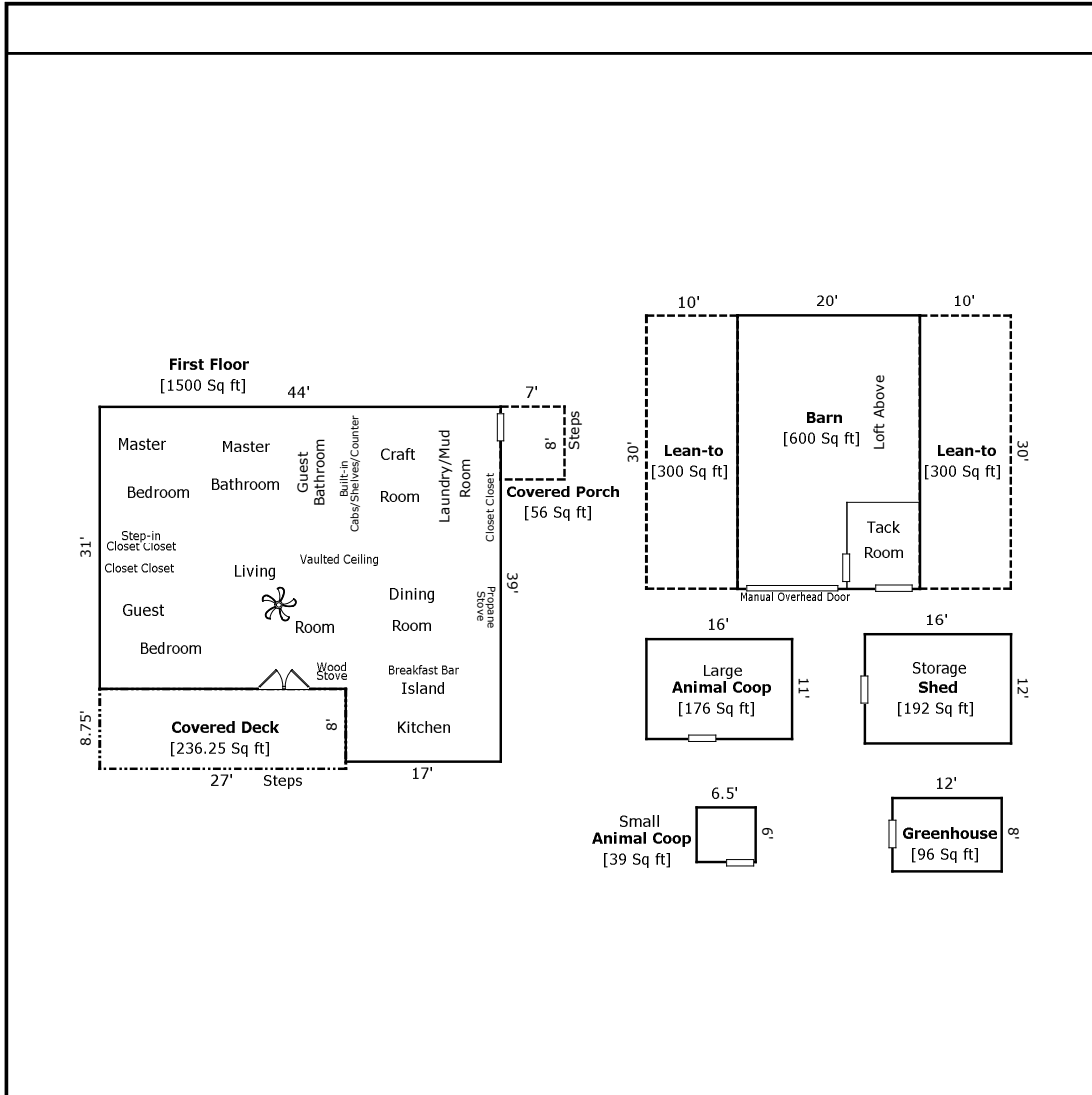

TOTAL Sketch by a la mode, inc.

Area Calculations Summary

Living Area		Calculation Details
First Floor	1500 Sq ft	$31 \times 27 = 837$ $39 \times 17 = 663$
Total Living Area (Rounded):	1500 Sq ft	
Non-living Area		
Barn	600 Sq ft	$30 \times 20 = 600$
Lean-to	300 Sq ft	$30 \times 10 = 300$
Lean-to	300 Sq ft	$30 \times 10 = 300$
Shed	192 Sq ft	$12 \times 16 = 192$
Animal Coop	176 Sq ft	$11 \times 16 = 176$
Greenhouse	96 Sq ft	$8 \times 12 = 96$
Animal Coop	39 Sq ft	$6 \times 6.5 = 39$
Covered Porch	56 Sq ft	$8 \times 7 = 56$
Covered Deck	236.25 Sq ft	$8.75 \times 27 = 236.25$

Building Sketch

Borrower	Steven & Hollie Ashworth			
Property Address	21 Old Trail Point Rd			
City	Noxon	County	Sanders	State MT Zip Code 59853
Lender	Rocky Mountain Bank			

